

TYPHOON

Product Description

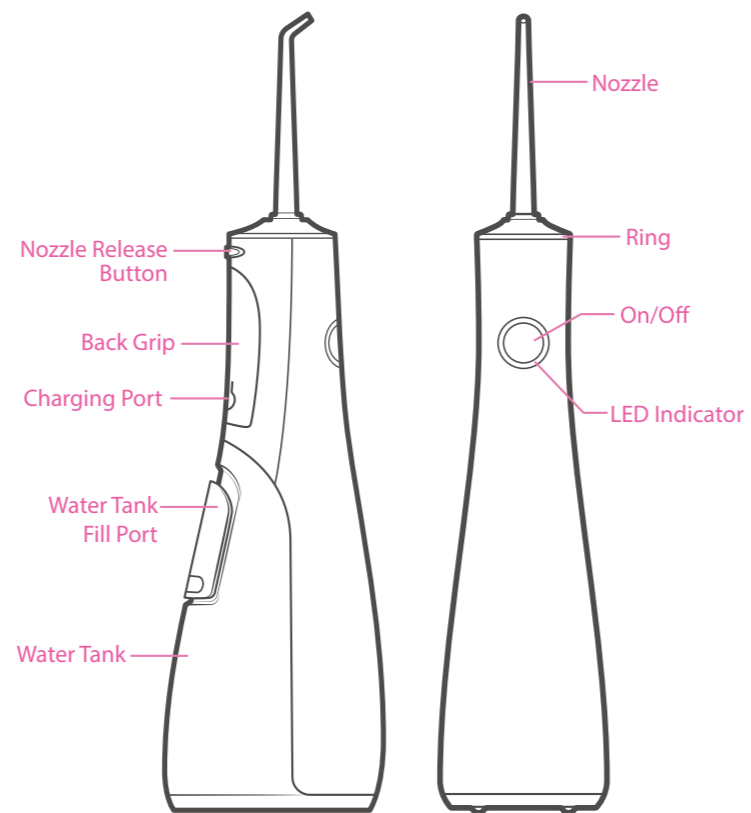

Features

- Waterproof and non-slip design
- Removable and replaceable nozzle
- High frequency water pulses effectively remove plaque and cleans between teeth
- USB charging function with LED indication of different modes
- Overcharge protector that shuts off charging when battery is fully charged
- Flosser will enter low power mode when battery is depleted
- 3 modes: regular, gentle, pulsating

Getting Ready

- 1 Make sure all wrapping and protective tape has been removed from Flosser
- 2 Fully charge Flosser before using
- 3 Charge by plugging USB cord into charging port of Flosser, then plug other end into USB charging block (not included), then plug into wall socket

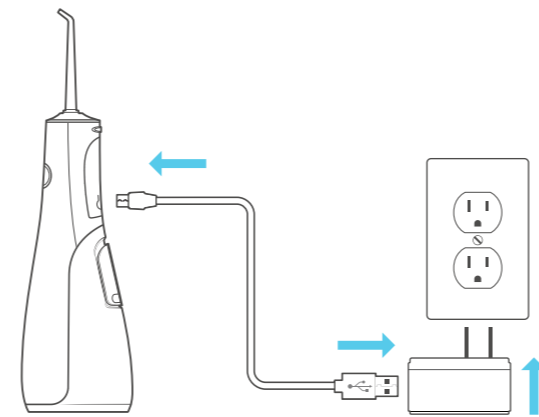

- 4 When battery is low, LED will begin flashing. This is the time to recharge your Flosser
- 5 When fully charged the LED will turn solid green

How to Use

- 1 Unplug Flosser from charging cord.
- 2 Fill water reservoir. It is recommended you use lukewarm water. DO NOT use water that is too hot.
- 3 Before turning on, place nozzle into mouth.
- 4 Place nozzle close to teeth without touching teeth.
- 5 Turn on power, find mode that is most comfortable for you.
 - Press on/off once for regular speed, twice for gentle, and three times for pulsating mode.
- 6 Move nozzle from tooth gap to the next tooth gap, spend about 1-2 seconds at each gap.
- 7 As water builds up in mouth, either let it drain out of mouth, or swallow it.
- 8 When finished, turn off Flosser while nozzle is still in your mouth to prevent water splashing.

Replacing Nozzle

- 1 Insert nozzle by pushing into nozzle hole until it clicks into place.
- 2 To remove nozzle, push nozzle release button and remove nozzle.
- 3 When not in use, store extra nozzles in safe place

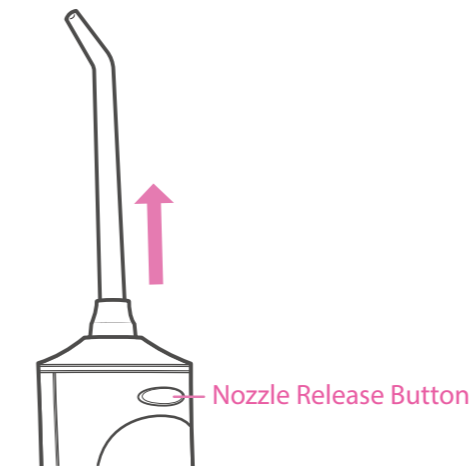

Daily Maintenance

- After using, dry off Flosser with dry, clean towel and store in dry, safe location.
- Occasionally remove Nozzle and rinse with warm water. With nozzle removed, clean nozzle port with cotton swab to prevent bacteria from building up.
- If bacteria is observed, use soap and water to clean the bacteria from the area.
- If not using the Flosser for extended periods of time, empty reservoir water and let it dry out before storing Flosser.
- DO NOT immerse the Flosser in water, it is not completely waterproof.

IMPORTANT:

If no water flows out of Flosser but you can feel air, then you must prime the pump by sucking air thru the tip very briefly - water should then flow shortly after you do this. Or you can empty the water out of the reservoir and tip the flosser upside down for 10-15 seconds to get air out of the tube. However, the first step is most effective. This is a common issue with all water flossers so don't be worried.

Specifications

- Water pressure: up to 90 PSI
- Input voltage: 5V
- Charging mode: USB
- Water tank capacity: 150 ML
- Pulse frequency: 1500-2000 times per minute
- Battery: Lithium Ion 1000 mAh
- Charging time: 3-4 hours
- Using time: 15-20 minute per charge
- Waterproof: IPX7
- Model number: FLO-0729

WARRANTY:

POP SONIC warrants the Typhoon for a period of 1 year after the original date of purchase, against defects due to faulty workmanship or materials. For warranty claims, you must register your device and log in to your account at WWW.SHOPPOPSONIC.COM, then select the option to make a warranty claim. Our customer service department will then contact you to initiate the warranty procedure.

This warranty covers working parts. It does not cover damage due to normal usage or accidents such as dropping the device. Other exclusions include misuse or neglect to the device.

This warranty is void if any other charging cables besides the one received is used with your device.

For any warranty claims, proof of purchase must be provided. For this reason, please keep your receipt for the duration of the warranty period.

Shipping costs are non-refundable.

Disposal Information:

The Typhoon should not be treated as normal household waste but should be brought to the appropriate collection point for recycling of electronic equipment.

Made in China

Made by Pop Sonic, LLC

Minneapolis, MN 55344

www.shoppopsonic.com