

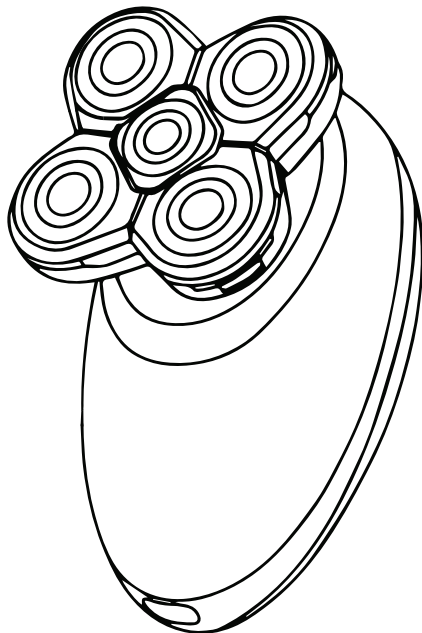

5.0 SHAVER

360 Precision

5-head Face, Head, and Body Shaver



5.0 SHAVER

INCLUDES:

- 5 head shaver
- USB charging cable

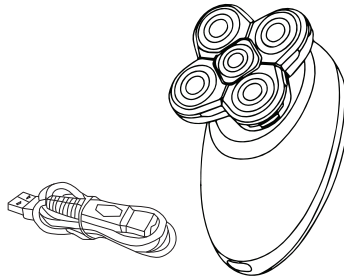

Using the Shaver

1. Make sure shaver is sufficiently charged and cord is detached from the unit.
2. Check to make sure foils are not broken or damaged. Make sure all foil head compartments are closed and locked.
3. Shaver can be used wet or dry, either way, use your free hand to pull the skin taut so that your hairs stand up rather than lay flat. If hairs lay flat you will need to go over the surface multiple times.
4. If using dry, move over shaving area several times, but take care to not press too hard or skin may be irritated, especially in the folds of the neck.
5. Wet shaving is preferable. It is best when skin is just damp and not too wet. Again, you will need to glide over the shaving surface several times to efficiently shave the skin.

6. Shaving creams can be used, but the shaver will need to be rinsed often, because the shaving cream will plug the foil openings if not rinsed frequently.
 7. Shaving oils can be used, but the shaving head should be rinsed thoroughly to make sure there is no oil residue.
 8. After each use it is suggested that you clean your shaver heads and examine the foils to make sure they are in good condition.
-

Cleaning & Maintenance

To ensure the best shaving experience, you should clean your shaver regularly. The best way to do this is to rinse off the heads with warm water after each use. Replacement heads are available for purchase.

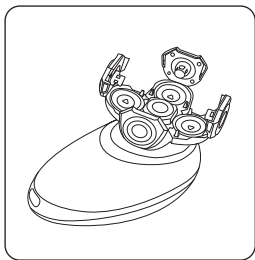

Make sure the shaver is turned off, open the shaver heads one by one. Lift each head off from the middle, as illustrated.

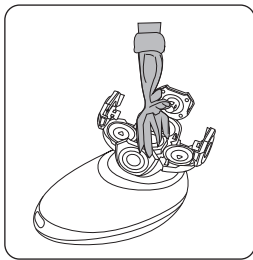

Rinse off all of the hair from the blades and then shake off excess water before closing the shaver heads.

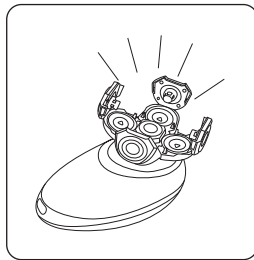

Do not use a towel or anything else to clean out shaver head compartments, or you may damage the blades.

General Maintenance

1. Never use abrasives, alcohol-based products, gasoline, or other dangerous substances to wash the shaver.
2. Use shaver lubricating oil and apply to moving parts. Access the moving parts by opening the shaver head compartments as instructed earlier.

Changing the Shaver Head

Change the shaver head once a year to get the best shaving effect. If damaged, the shaver head can only be replaced with a shaver head from Pop Sonic.

1. The 5.0 shaver head should be replaced after the existing blades become dull and don't cut as well or if the foils become damaged.
2. To replace the shaver head, simply pull the entire shaver head from the base. Grip the shaver head by the connecting point and pull upwards, it should pop off fairly easily.
3. Take the new shaver head and insert it into the base until it is secure, you should hear a clicking sound once it is secure.

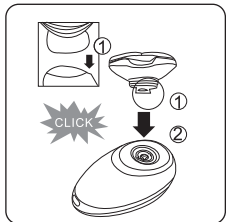
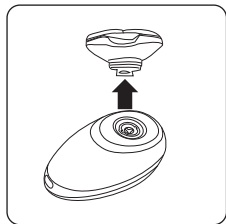

Warning

Before using the product, please carefully read the operating instructions and keep properly for future reference.

1. Only adults should use the shaver. Children should only handle the shaver when supervised by an adult.
2. The shaver foils are very thin and should be handled carefully. If damaged, replace the shaver head before using again.
3. Never use the USB cord if it is frayed or damaged.
4. Store the shaver in a low moisture area when not in use.
5. The shaver works best on short facial hairs, shorter scalp hairs, and shorter legs and body hairs.
6. This shaver is water resistant and can be used in damp and moist situations, but should not be submerged in water for any length of time.

Disposal

When disposing of your shaver, do not put it with your everyday trash, it should be recycled due to the lithium ion battery in it.

Specifications

Powered by Lithium Ion battery
Charging time: 90 minutes
Usage: up to 60 minutes per charge

Water Resistance: IPX5
Charging: 100-240V
Input: 5V - 1000mA

Warranty

POP SONIC warrants the 5.0 Shaver for a period of 1 year after the original date of purchase, against defects due to faulty workmanship or materials. For warranty claims, you must register your device and log in to your account at www.shoppopsonic.com, then select the option to make a warranty claim. Our customer service department will then contact you to initiate the warranty procedure.

This warranty covers working parts. It does not cover damage due to normal usage or accidents such as dropping the device.

Other exclusions include misuse or neglect to the device. This warranty is void if any other charging cables besides the one included is used with your device.

For any warranty claims, proof of purchase must be provided. For this reason, please keep your receipt for the duration of the warranty period.
Shipping costs are non-refundable.

Support

For questions about your product please call Pop Sonic customer services at (800) 772-9147 or email help@shoppopsonic.com

Made By Pop Sonic, LLC
Minneapolis, MN 55344 , USA
MADE IN CHINA

